

# ROSE PRECISION

## SPHERICAL BEARINGS

## ROD ENDS

ground track

### SPECIFICATION

**HOUSING** NICKEL CHROMIUM MOLYBDENUM STEEL, HEAT TREATED TO 80/90 TONS TENSILE (EN25, KE805 OR EQUIVALENT).

**FINISH** BLACK ENAMEL EXCEPT ON BEARING SURFACE, FACES AND THREAD.

**BALL** ONE PER CENT CARBON CHROMIUM STEEL (EN31 OR EQUIVALENT) HEAT TREATED TO 60/62 ROCKWELL 'C'.

ALL DIMENSIONS GIVEN IN INCHES.

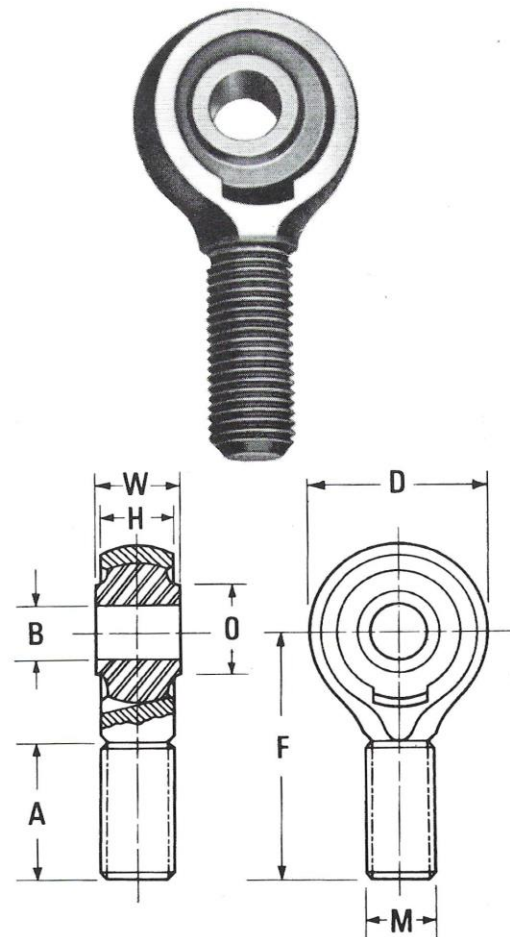

## RBJ series male thread

BEARING NUMBER	B	W	H	O	D	F	A	M		Ball Diameter	Maximum Static Load in Pounds Approx.	Weight in Pounds Approx.
	Bore	Ball Width	Housing Width	Ball Flat Diameter	Head Diameter	Centre Length	Thread Length	Medium Fit				
	+·00025 -·00025	+·000 -·005	+·005 -·005		+·010 -·010	+·010 -·010	+·010 -·010	BSF	Hand			
RBJ 37	·250	·375	·320	·375	·812	1·312	·625	$\frac{5}{16}$	RH	·625	2,800	·053
RBJ 38	·250	·375	·320	·375	·812	1·312	·625	$\frac{5}{16}$	LH	·625	2,800	·053
RBJ 40	·312	·437	·375	·437	·937	1·500	·750	$\frac{3}{8}$	RH	·720	4,400	·084
RBJ 41	·312	·437	·375	·437	·937	1·500	·750	$\frac{3}{8}$	LH	·720	4,400	·084
<b>FORGINGS</b>	+·00025 -·00025	+·000 -·005	+·005 -·005		+·030 -·010	+·010 -·010	+·010 -·010					
RBJ 43	·375	·562	·480	·562	1·218	1·875	1·000	$\frac{1}{2}$	RH	·937	6,300	·189
RBJ 44	·375	·562	·480	·562	1·218	1·875	1·000	$\frac{1}{2}$	LH	·937	6,300	·189
RBJ 46	·500	·750	·640	·750	1·625	2·375	1·250	$\frac{5}{8}$	RH	1·250	11,200	·430
RBJ 47	·500	·750	·640	·750	1·625	2·375	1·250	$\frac{5}{8}$	LH	1·250	11,200	·430
	+·0005 -·00025	+·000 -·005	+·005 -·005		+·030 -·010	+·010 -·010	+·010 -·010					
RBJ 49	·625	·875	·750	·875	1·937	2·750	1·500	$\frac{3}{4}$	RH	1·437	17,500	·687
RBJ 50	·625	·875	·750	·875	1·937	2·750	1·500	$\frac{3}{4}$	LH	1·437	17,500	·687
RBJ 52	·750	·875	·812	1·000	2·125	3·125	1·750	$\frac{7}{8}$	RH	1·500	25,000	·875
RBJ 53	·750	·875	·812	1·000	2·125	3·125	1·750	$\frac{7}{8}$	LH	1·500	25,000	·875

All rod ends having a bore greater than  $\frac{1}{2}$ " diameter are fitted with lubricators.

For further information refer to Technical index.